

UHF(Female) Straight Cable Jack,  
DC to 300 MHz

UHF2CN0-G316A/H3

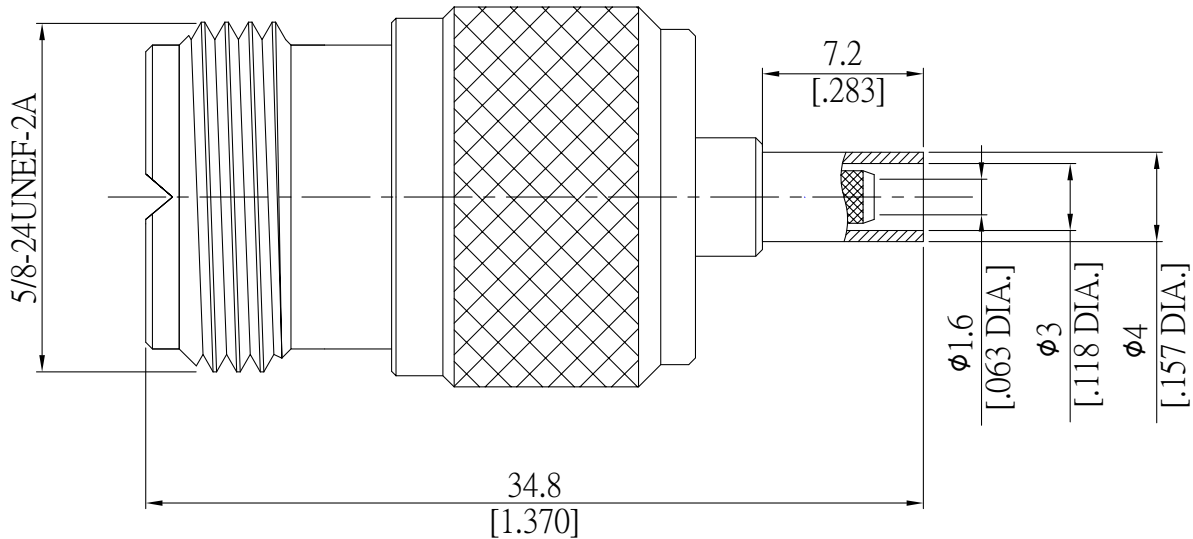

All dimensions are in mm [inch]

Tolerances according to DIN ISO 2768-mH

**Interface**

According to IEC 60169-12

**Electrical Data**

Impedance non-constant  
Frequency DC to 300 MHz

- Limitations are possible due to the used cable type and manufacturing process -

**Mechanical Data**

Coupling mechanisms Screw-lock  
Centre contact Soldered or Crimped  
Cable entry Crimped

**Environmental Data**

Temperature range -55°C to +149°C  
RoHS compliant

**Material And Plating**

Connector parts	Material	Plating
Centre contact	Brass	Gold plating(Nickel underplated)
Body	Brass	Nickel
Insulator	PTFE	
Crimp ferrule	Brass	Nickel

**Suitable Cables**

RG-174, RG-188A, RG-316, BELDEN 7805

**Packing**

Single or 100

UHF(Female) Straight Cable Jack,  
DC to 300 MHz

UHF2CN0-G316A/H3

**Recommended Cable Stripping Dimensions**

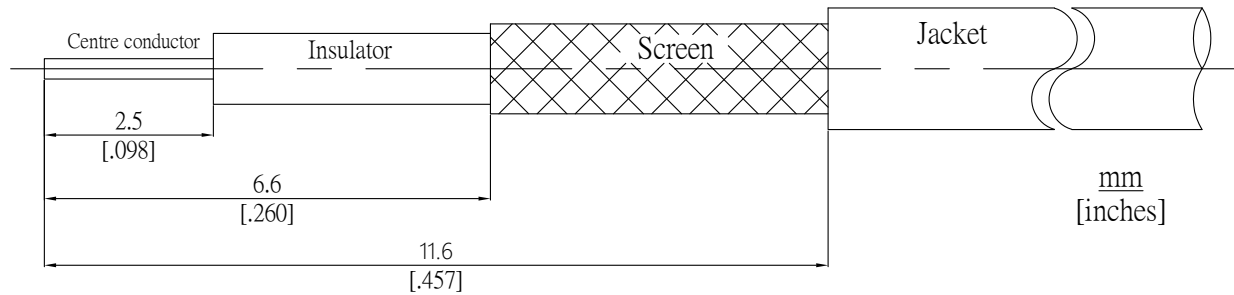

**Crimp Dimensions**

Crimp ferrule 3.25 mm [.128 inch] HEX  
Center Contact 0.7 mm [.028 inch] SQ