

UHF Plug (Male) Cable Connector

UHF1CN0-G213-214AA/144

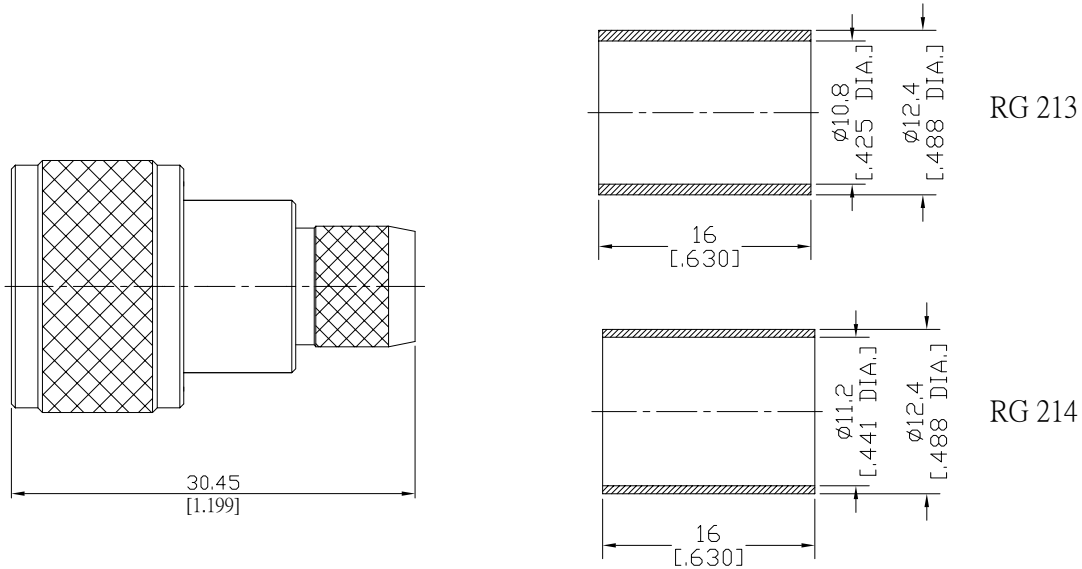

All dimensions are in mm [inch]
Tolerances according to DIN ISO 2768-mH

Interface

According to IEC 60169-12

Electrical Data

Impedance non-constant
Frequency DC to 300 MHz

- Limitations are possible due to the used cable type and manufacturing method -

Mechanical Data

Coupling mechanisms Screw-lock
Centre contact Solder or Crimp
Cable entry Crimp

Environmental Data

Temperature range -55°C to +149°C
RoHS compliant
REACH compliant

Material And Plating

Connector parts	Material	Plating
Centre contact	Brass	Gold plating(Nickel underplated)
Body	Brass	Copper-Tin-Zinc Alloy
Insulator	PTFE	
Coupling nut	Brass	Copper-Tin-Zinc Alloy

Suitable Cables

RG-213, RG-214, RG-393

Packing

Single or 100

UHF Plug (Male) Cable Connector

UHF1CN0-G213-214AA/144

Cable Stripping Dimensions

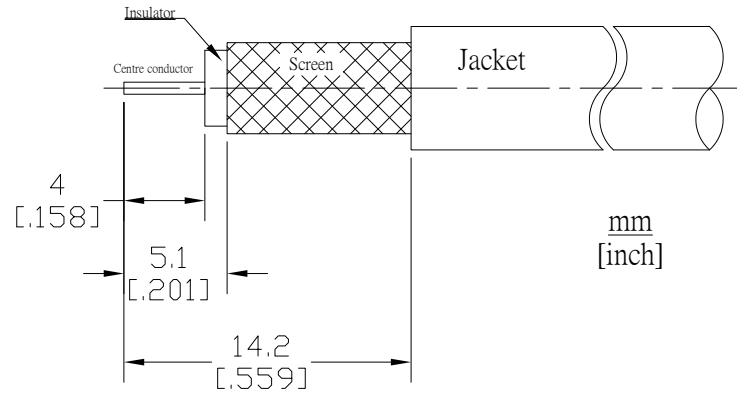

Crimp Dimensions [HEX]

Crimp ferrule 10.90mm [.429 inch]
Centre contact 2.54mm [.100 inch]