

1 Watt RF Termination Up to 40 GHz With  
SMP Jack (Female) Gold Plated Beryllium Copper

T-P25-40G1WA/99

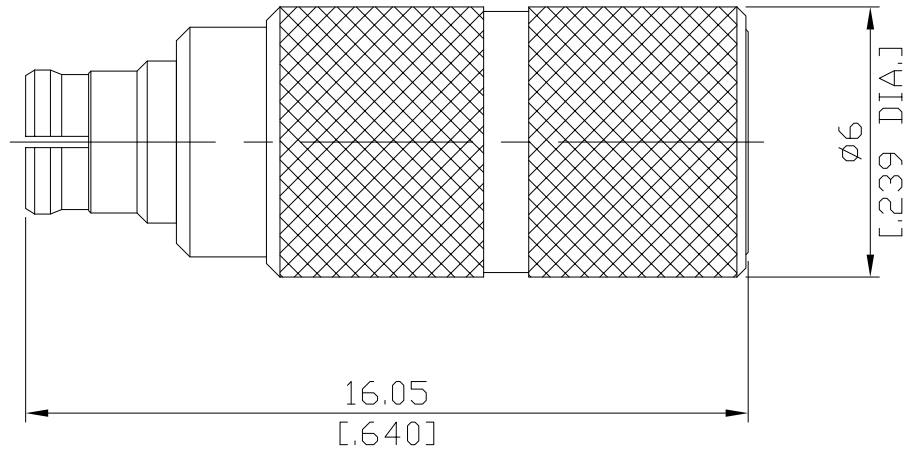

All dimensions are in mm [inch]  
Tolerances according to DIN ISO 2768-mH

**Interface**

According to MIL-STD-348A/326  
Mateable with GPO™ (Gilbert Engineering Co., Inc)

**Electrical Data**

Impedance 50 Ω  
Interface frequency max. DC to 40 GHz  
VSWR (Return loss) ≤ 1.20 (≥ 20.83 dB)  
Power rating (Watt) 1 W

**Mechanical Data**

Coupling mechanisms Snap-On  
Weight 0.0053 kg

**Environmental Data**

Temperature range -55°C to +125°C  
RoHS compliant

**Material And Plating**

Connector parts	Material	Plating
Centre contact	Beryllium Copper	Gold plating(Nickel underplated)
Body	Beryllium Copper	Gold plating(Nickel underplated)
Insulator	PEI	

**Packing**

Single