

1 Watt Termination Up to 40 GHz With  
SMP Jack (Female)

T-P25-40G1WA/91

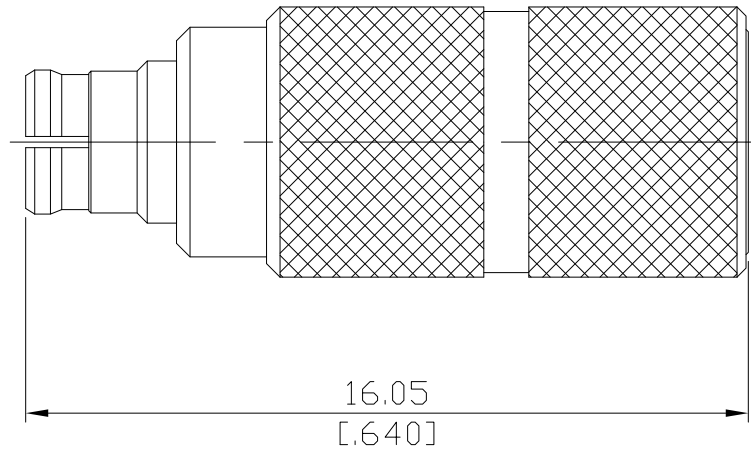

All dimensions are in mm [inch]

Tolerances according to DIN ISO 2768-mH

**Interface**

According to IEC 61169-35; MIL-STD-348A/326  
Mateable with GPO™ (Gilbert Engineering Co., Inc)

**Electrical Data**

Impedance 50 Ω  
Interface frequency max. DC to 40 GHz  
VSWR ≤ 1.20 (20.8 dB)  
Power rating (Watt) 1 W

**Mechanical Data**

Coupling mechanisms Snap-On  
Weight 0.0053 kg

**Environmental Data**

Temperature range -55°C to +125°C  
RoHS compliant

**Material And Plating**

Connector parts	Material	Plating
Centre contact	Beryllium Copper	Gold plating (Nickel underplated)
Body	Brass	Gold plating (Nickel underplated)
Insulator	PS	

**Packing**

Single