

SMC Straight Bulkhead Receptacle Jack  
Solder End

SMC2FB50-1500B/11

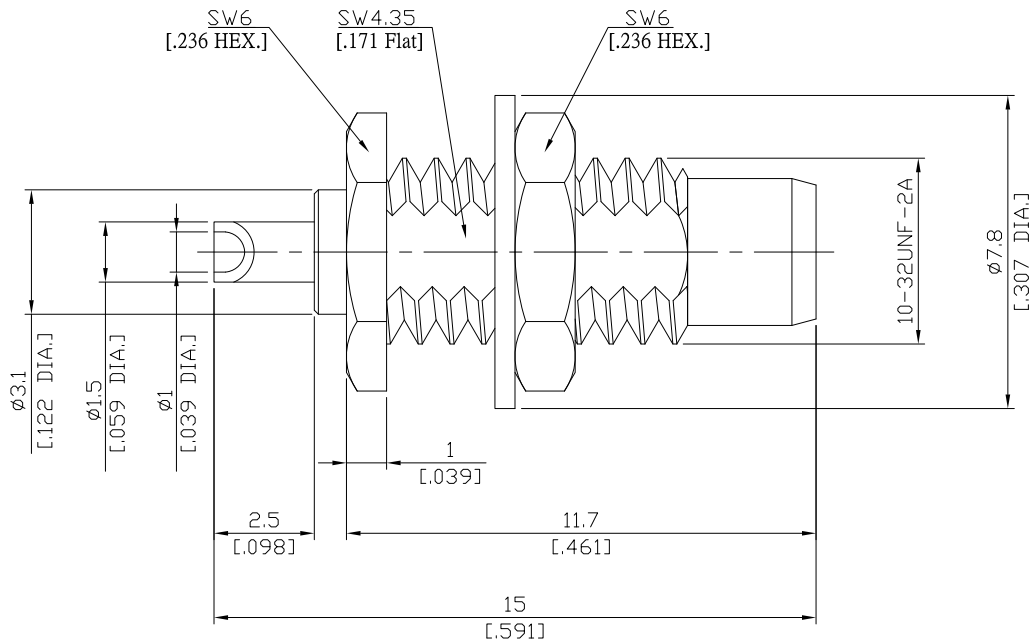

All dimensions are in mm [inch]

Tolerances according to DIN ISO 2768-mH

**Interface**

According to IEC 60169-9; MIL-C-39012; MIL-STD-348A/312

**Electrical Data**

Impedance 50  $\Omega$   
Frequency DC to 10 GHz

**Mechanical Data**

Coupling mechanisms Screw-lock  
Weight 0.0014 kg

**Environmental Data**

Temperature range -65°C to +165°C  
RoHS compliant

**Material And Plating**

Piece Parts	Material	Plating
Centre contact	Brass	Gold plating(Nickel underplated)
Body	Brass	Gold plating(Nickel underplated)
Insulator	PTFE	
Fastening nut	Brass	Gold plating(Nickel underplated)
Washer	Brass	Gold plating(Nickel underplated)

**Packing**

Single or 100

**Related Document**

Mounting Dimension MD4