

SMA Straight Panel Receptacle Jack (Coaxial End)

SMA2GFA50-2060A-EC/9X

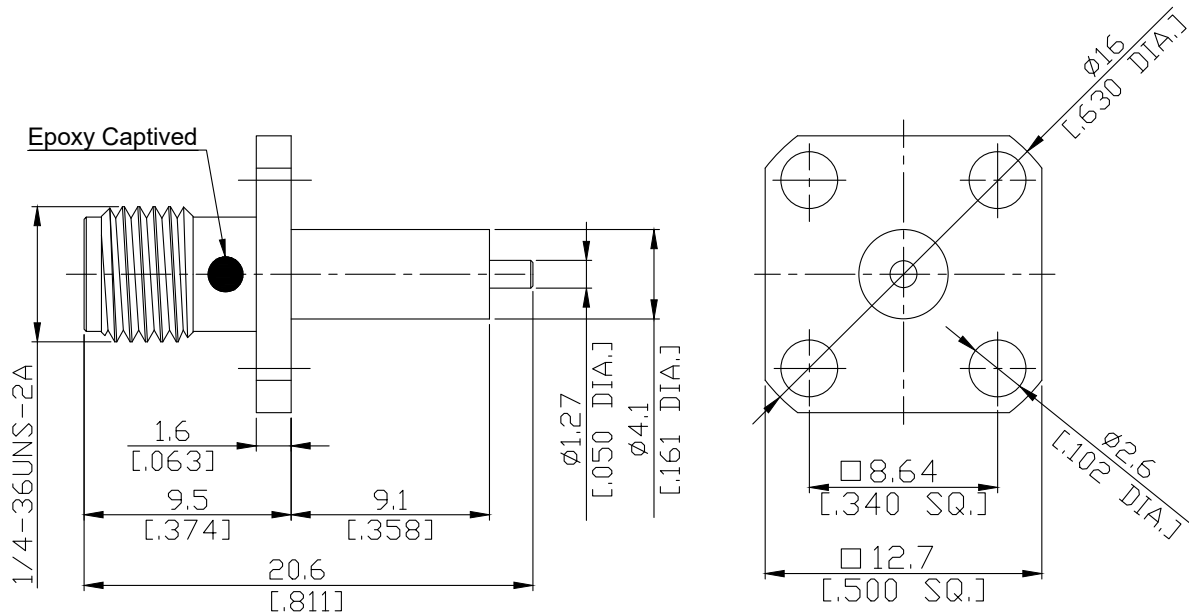

All dimensions are in mm [inch]
Tolerances according to DIN ISO 2768-mH

Interface
According to MIL-C-39012;MIL-STD-348A/310

Electrical Data
Impedance: 50 Ω
Frequency: DC to 18 GHz
VSWR (Return Loss): ≤ 1.25 (≥ 19.08 dB)
Insertion Loss: $\leq 0.05 \times \sqrt{F}$ (GHz) dB

Mechanical Data
Coupling mechanisms: Screw-lock
Weight: N/A

Environmental Data
Temperature range: -65°C to +165°C
RoHS: compliant

Material And Plating		
Piece Parts	Material	Plating
Centre contact	Beryllium Copper	Gold plating(Nickel underplated)
Body	Stainless Steel	Passivated
Insulator	PTFE	

Packing
Single or 100

Related Document
Mounting Dimension: MD71