

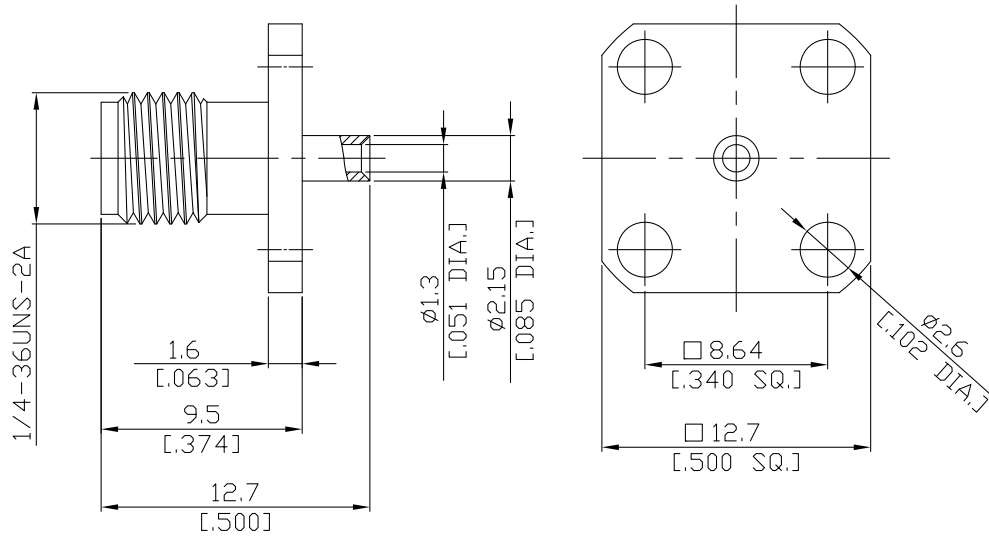

SMA Straight 4 Hole Panel Flange  
Cable Jack

SMA2EBF50-0047A/91



All dimensions are in mm [inch]

**Interface**

According to IEC 60169-15; MIL-C-39012; MIL-STD-348A/310

**Electrical Data**

Impedance 50  $\Omega$   
 Frequency DC to 18 GHz  
 VSWR (Return Loss)  $\leq 1.25$  ( $\geq 19.1$  dB)  
 Insertion Loss  $\leq 0.04 \times \sqrt{F}$  (GHz) dB

- Limitations are possible due to the used cable type -

**Mechanical Data**

Coupling mechanisms Screw-lock  
 Centre contact Soldered or Crimped  
 Cable entry Soldered

**Environmental Data**

Temperature range -65°C to +165°C  
 RoHS compliant

**Material And Plating**

Connector parts	Material	Plating
Centre contact	Beryllium Copper	Gold plating(Nickel underplated)
Body	Brass	Gold plating(Nickel underplated)
Insulator	PTFE	

**Suitable Cables**

RSR-047, RSF-047, RSF-047-FEP, RSF-047-PVC

**Packing**

Single or 100

**Related Document**

Mounting Dimension MD10