

## SMA Straight Panel Receptacle Plug (Coaxial End)

## SMA1GTA50-1700A-EC/1XX

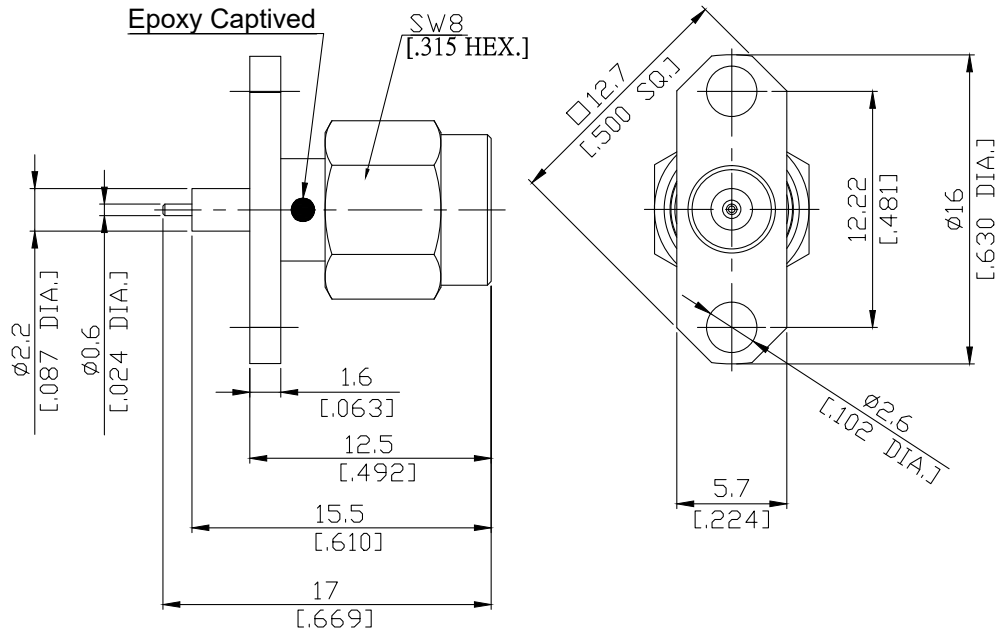

All dimensions are in mm [inch]  
Tolerances according to DIN ISO 2768-mH

**Interface**  
According to MIL-C-39012; MIL-STD-348A/310

**Electrical Data**  
Impedance 50  $\Omega$   
Frequency DC to 18 GHz  
VSWR (Return Loss)  $\leq 1.25$  ( $\geq 19.08$  dB)  
Insertion Loss  $\leq 0.05 \times \sqrt{F}$  (GHz) dB

**Mechanical Data**  
Coupling mechanisms Screw-lock  
Weight 0.0032 kg

**Environmental Data**  
Temperature range -65°C to +165°C  
RoHS compliant

**Material And Plating**

Piece Parts	Material	Plating
Centre contact	Brass	Gold plating(Nickel underplated)
Body	Stainless Steel	Passivated
Insulator	PTFE	
Gasket	Silicone Rubber	
Coupling nut	Stainless Steel	Passivated

**Packing**  
Single or 100

**Related Document**  
Mounting Dimension MD76