

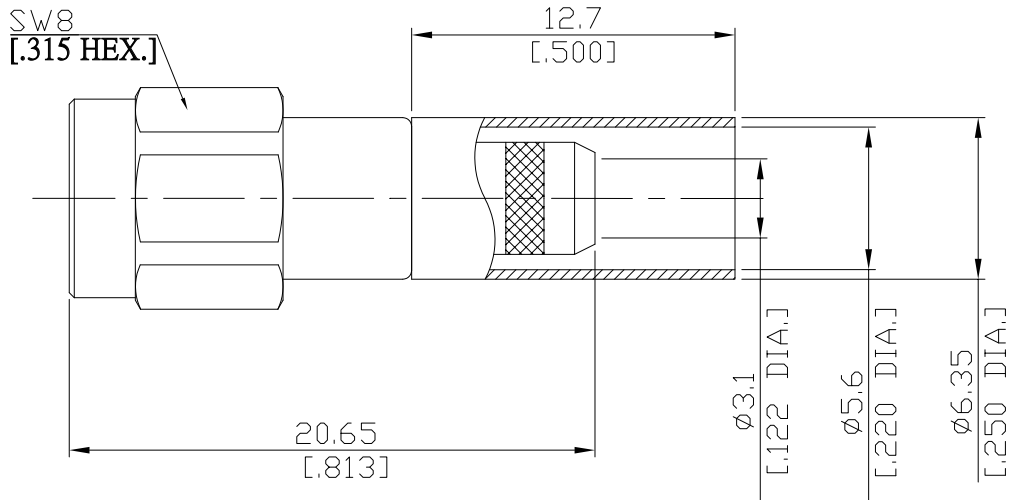

SMA(Male) Straight Cable Plug,  
DC-6 GHz

SMA1C50-G142C/133



All dimensions are in mm [inch]  
Tolerances according to DIN ISO 2768-mH

**Interface**

According to IEC 60169-15; MIL-STD-348A/310

**Electrical Data**

Impedance 50 Ω  
Frequency DC to 6 GHz  
VSWR (Return Loss) ≤ 1.20 (≥ 20.83 dB), DC to 5 GHz  
Insertion Loss ≤ 0.04 × √F [GHz] dB, DC to 5 GHz

- Limitations are possible due to the used cable type and manufacturing process -

**Mechanical Data**

Coupling mechanisms Screw-lock  
Centre contact Soldered or Crimped  
Cable entry Crimped

**Environmental Data**

Temperature range -65°C to +165°C  
RoHS compliant

**Material And Plating**

Connector parts	Material	Plating
Centre contact	Brass	Gold plating(Nickel underplated)
Body	Brass	Nickel
Insulator	PTFE	
Gasket	Silicone Rubber	
Coupling nut	Brass	Nickel
Crimp ferrules	Brass	Nickel

**Suitable Cables**

RG-55, RG-142, RG-223, RG-400

**Packing**

Single, 5-pack, or 100

SMA(Male) Straight Cable Plug,  
DC-6 GHz

SMA1C50-G142C/133

**Recommended Cable Stripping Dimensions**

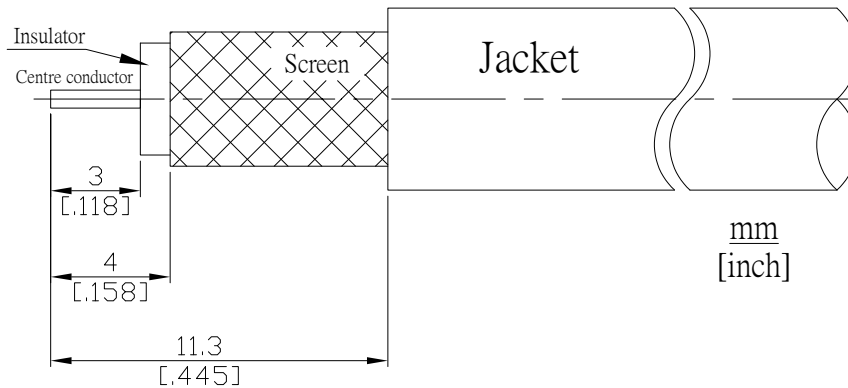

**Crimp Dimensions [HEX]**

Crimp ferrule	5.41 mm [.213 inch]
Centre contact	1.73 mm [.068 inch]