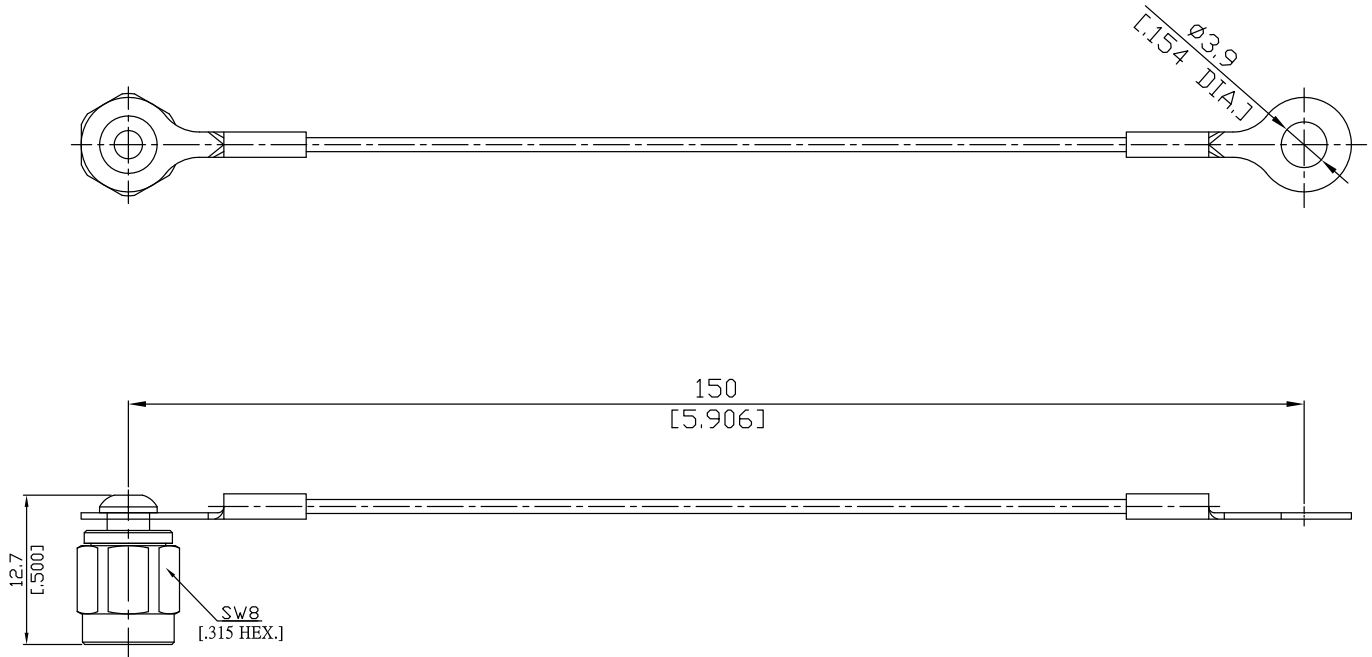

**SMA Straight Protective Cap With Wire Rope Chain Plug**
**SMA1A00-1270B-150/-11**

All dimensions are in mm [inch]  
Tolerances according to DIN ISO 2768-mH

**Mechanical Data**

Coupling mechanisms Screw-lock  
Weight N/A

**Environmental Data**

Temperature range -65°C to +165°C  
RoHS compliant

**Material And Plating**

Connector parts	Material	Plating
Body	Brass	Gold plating(Nickel underplated)
Gasket	Silicone Rubber	
Coupling nut	Brass	Gold plating(Nickel underplated)
Chain	Stainless Steel	N/A

**Packing**

Single or 100