

N (Male) Straight Cable Plug,
DC-6 GHz, VSWR ≤ 1.30

N1C50-R400A/133

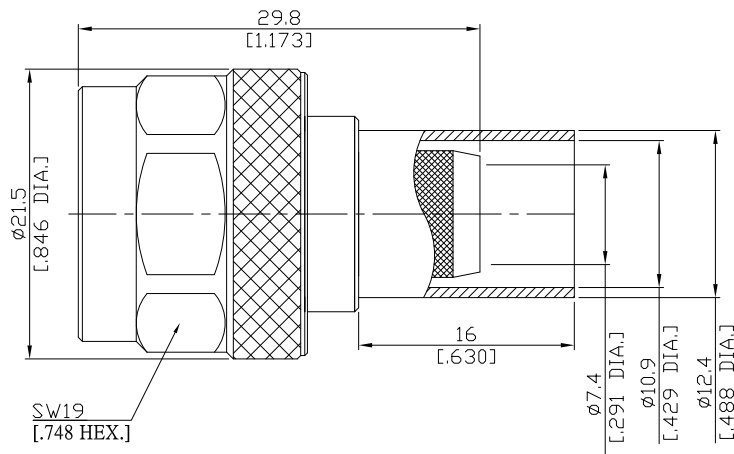

All dimensions are in mm [inch]

Tolerances according to DIN ISO 2768-mH

Interface

According to

IEC 60169-16; MIL-STD-348A/304

Electrical Data

Impedance

 $50\ \Omega$

Frequency

DC to 6 GHz

VSWR (Return Loss)

 ≤ 1.30 (≥ 17.69 dB)

- Digressions are possible due to the used cable type and manufacturing process-

Mechanical Data

Coupling mechanisms

Screw-lock

Centre contact

Soldered or Crimped

Cable entry

Crimped

Environmental Data

Temperature range

-65°C to +165°C

RoHS

compliant

Material And Plating

Connector parts	Material	Plating
Centre contact	Brass	Gold plating(Nickel underplated)
Body	Brass	Nickel
Insulator	PTFE	
Gasket	Silicone Rubber	
Coupling nut	Brass	Nickel
Crimp ferrules	Brass	Nickel

Suitable Cables

LMR 400; RNL-400; Belden 7810A, 8214, 9913

Packing

Single or 100

N (Male) Straight Cable Plug,
DC-6 GHz, VSWR ≤ 1.30

N1C50-R400A/133

Recommended Cable Stripping Dimensions

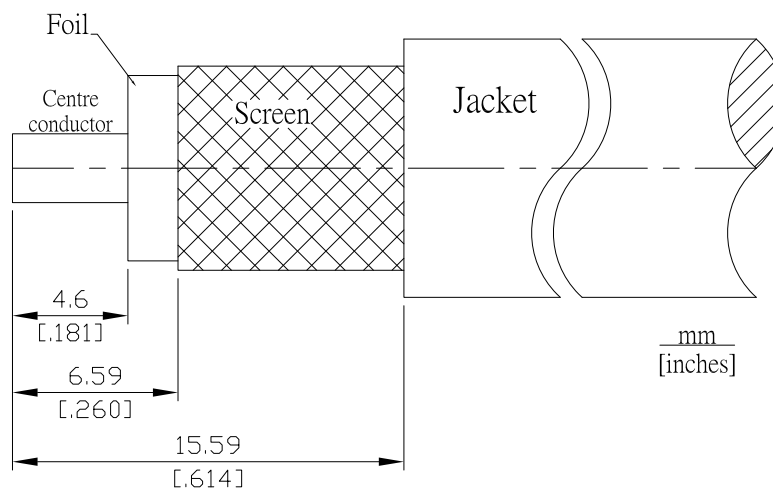

Crimp Dimensions [HEX]

Crimp ferrule	10.9 mm [.429 inch]
Center Contact	3 mm [.118 inch]