

Impedance Matching Pads plug/plug
SMA 50 plug (male) / F 75 plug (male)

MP-A15F17A-2G/H44-H44

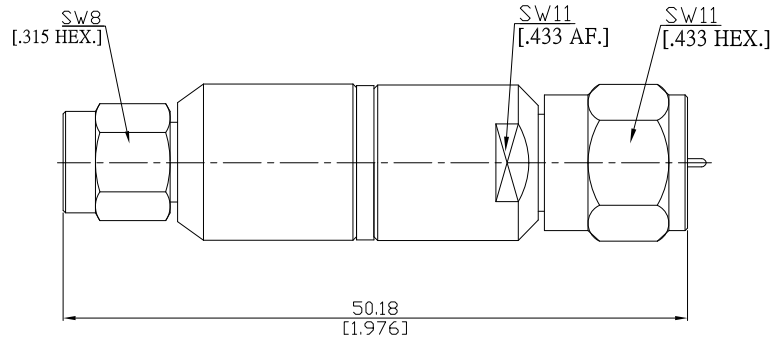

All dimensions are in mm [inch]

Tolerances according to DIN ISO 2768-mH

Interface

According to MIL-C-39012; MIL-STD-348A/310

Electrical Data

Impedance SMA 50 Ω / F 75 Ω
Frequency DC to 2 GHz
VSWR (Return loss) ≤ 1.25
Insertion loss 5.7 ± 0.5 dB
Input power 2 W Avg. @ + 25°C
Peak power ≤ 250 W

Mechanical Data

Coupling mechanisms SMA (Screw-lock) ; F (Screw-lock)
Weight N/A

Environmental Data

Temperature range -40°C to +85°C
RoHS compliant

Material And Plating

Piece Parts (SMA)	Material	Plating
Centre contact	Phosphor Bronze	Gold plating(Nickel underplated)
Body	Brass	Copper-Tin-Zinc Alloy
Insulator	PTFE	
Gasket	Silicone Rubber	
Coupling nut	Brass	Copper-Tin-Zinc Alloy
Piece Parts (F)	Material	Plating
Centre contact	Phosphor Bronze	Gold plating(Nickel underplated)
Body	Brass	Copper-Tin-Zinc Alloy
Insulator	PTFE	
Coupling nut	Brass	Copper-Tin-Zinc Alloy

Packing

Single or 100