

Fixed Attenuator plug/jack  
QMA plug (male) / QMA jack (female)

FA-QA1QA25A-3G2W- -/944-94

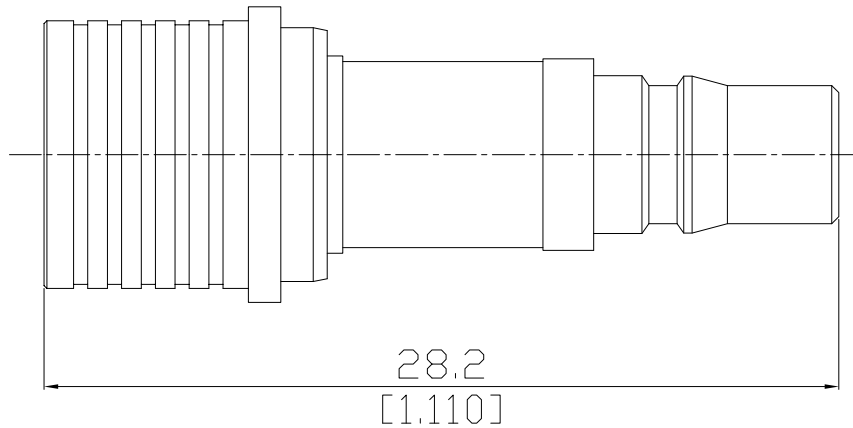

All dimensions are in mm [inch]

Tolerances according to DIN ISO 2768-mH

**Interface**

According to IEC 61169-50

**Electrical Data**

Impedance 50 Ω  
 Frequency DC to 3 GHz  
 VSWR (Return Loss) ≤ 1.25 (≥ 19.08 dB)  
 Power rating 2 Watt average power up to 25 °C

**Maximum Deviation Over Frequency**

Nominal ATTN (dB)	Deviation (dB)
1-10	±0.4
11-30	±0.5

**Mechanical Data**

Coupling mechanisms Quick-lock  
 Weight N/A

**Environmental Data**

Temperature range -55°C to +130°C  
 RoHS compliant

**Material And Plating**

Piece Parts (QMA)	Material	Plating
Centre contact	Beryllium Copper	Gold plating (Nickel underplated)
Body	Brass	Copper-Tin-Zinc Alloy
Insulator	PTFE	

Piece Parts (QMA)	Material	Plating
Centre contact	Beryllium Copper	Gold plating (Nickel underplated)
Body	Brass	Copper-Tin-Zinc Alloy
Insulator	PTFE	

**Packing**

Single or 100