

BMA Jack (Female) Slide-On Panel Connector Solder Attachment
2 Hole Flange Mount DC-26.5 GHz VSWR1.20

BMA2GTA50-1495A-EC / 99X

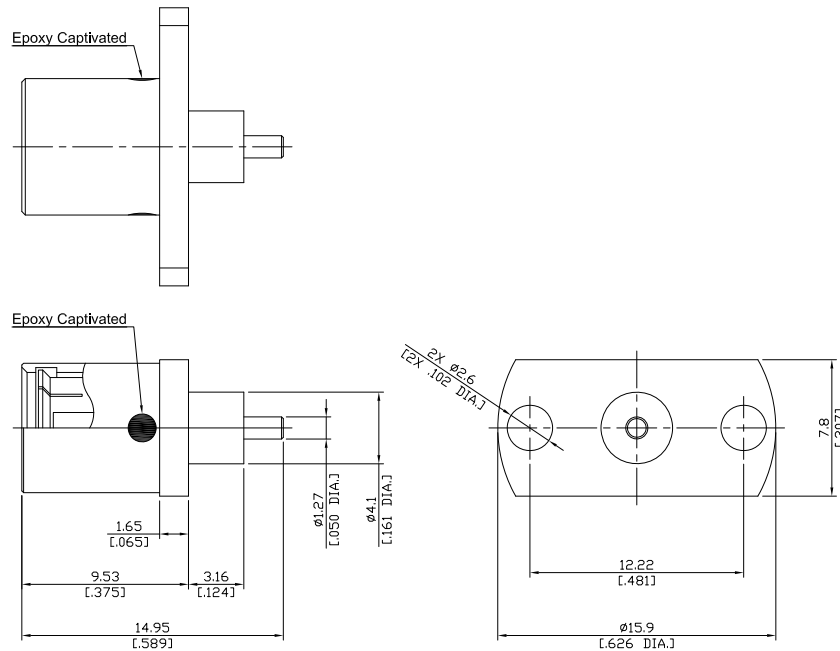

All dimensions are in mm [inch]

Tolerances according to DIN ISO 2768-mH

Interface

According to IEC 61169-33; MIL-STD-348B/321

Electrical Data

Impedance 50 Ω
 Frequency DC to 26.5 GHz
 VSWR (Return Loss) ≤ 1.20 (≥ 20.8 dB)
 Insertion Loss ≤ 0.05 x √F (GHz) dB

Mechanical Data

Coupling Mechanisms Slide-on
 Mating Cycles ≥ 1000
 Center Contact Captivation ≥ 27 N
 Engagement Force ≤ 13.5 N
 Disengagement Force ≥ 2 N
 Captivation Epoxy Captivation

Environmental Data

Temperature Range -65°C to +165°C
 RoHS compliant

Material And Plating

Piece Parts	Material	Plating
Centre contact	Beryllium Copper	Gold plating, 3 μinch (Non-magnetic nickel-phosphorus underplating, 80 μinch)
Contact Body	Beryllium Copper	Gold plating, 3 μinch (Non-magnetic nickel-phosphorus underplating, 80 μinch)
Body	Stainless Steel	Passivated
Insulator	PTFE	

Packing

Single or 100