

L-adaptor plug/jack
F plug (male) / F jack (female)

ADL-F1F27A/144-94

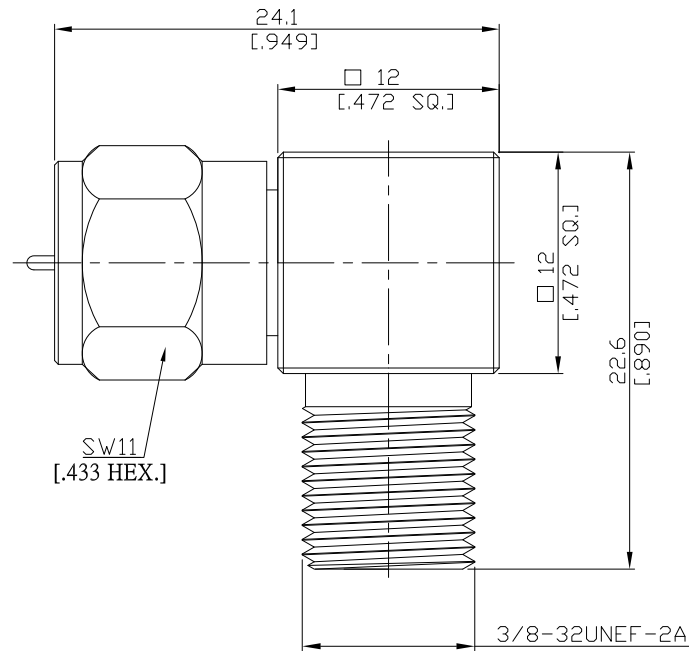

All dimensions are in mm [inch]
Tolerances according to DIN ISO 2768-mH

Interface

According to N/A

Electrical Data

Impedance 50 Ω
Frequency DC to 1 GHz

Mechanical Data

Coupling mechanisms Screw-lock
Weight 0.0184 kg

Environmental Data

Temperature range -40°C to +60°C
RoHS compliant

Material And Plating

Piece Parts (F)	Material	Plating
Centre contact	Brass	Gold plating(Nickel underplated)
Body	Brass	Copper-Tin-Zinc Alloy
Insulator	PTFE	
Coupling nut	Brass	Copper-Tin-Zinc Alloy
Piece Parts (F)	Material	Plating
Centre contact	Beryllium Copper	Gold plating(Nickel underplated)
Body	Brass	Copper-Tin-Zinc Alloy
Insulator	PTFE	

Packing

Single or 100