

Adaptor Jack / Jack
SHV jack (female) / SHV jack (female)

AD-SV2SV25A/14-14

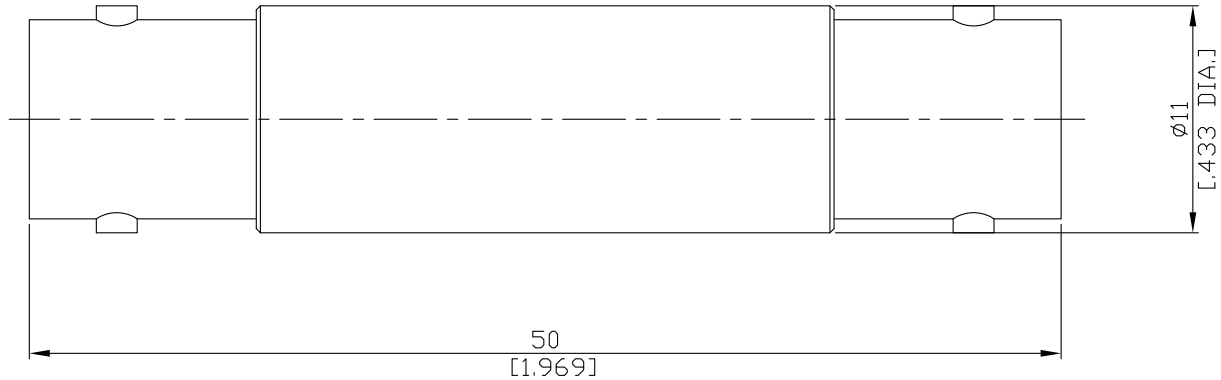

All dimensions are in mm [inch]
Tolerances according to DIN ISO 2768-mH

Interface

According to MIL-C-39012;MIL-STD-348A/314

Electrical Data

Impedance 50 Ω
Frequency DC to 300 MHz

Mechanical Data

Coupling mechanisms Bayonet-lock
Weight 0.0186 kg

Environmental Data

Temperature range -65°C to +165°C
RoHS compliant

Material And Plating

Piece Parts (SHV)	Material	Plating
Centre contact	Brass	Gold plating(Nickel underplated)
Body	Brass	Copper-Tin-Zinc Alloy
Insulator	PTFE	

Piece Parts (SHV)	Material	Plating
Centre contact	Brass	Gold plating(Nickel underplated)
Body	Brass	Copper-Tin-Zinc Alloy
Insulator	PTFE	

Packing

Single or 100