

Panel Adaptor plug/jack
SMP plug (male) / Precision SMA jack (female)

AD-PS1PCA25A-PT/9X-9X

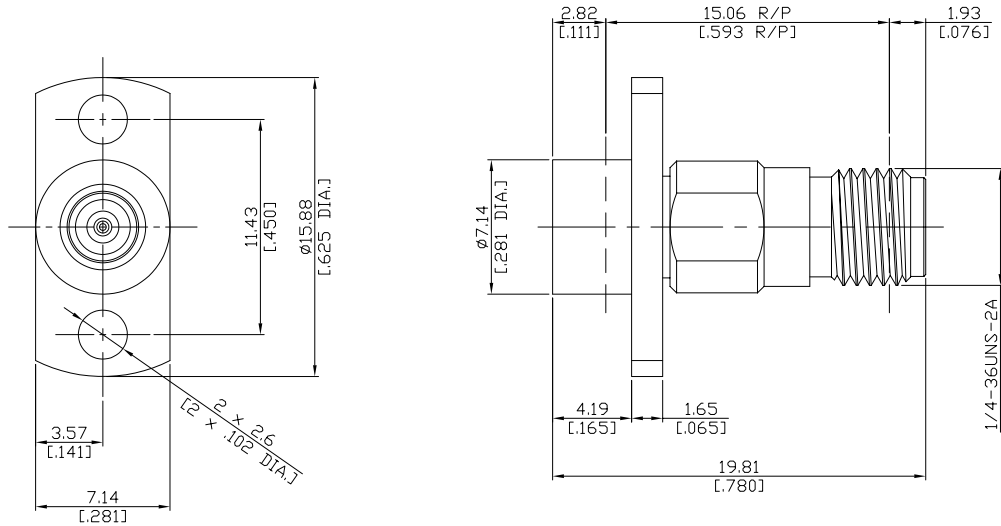

All dimensions are in mm [inch]

Tolerances according to DIN ISO 2768-mH

Interface

SMP (smooth bore) according to
SMA according to

MIL-STD-348/326.4
IEC 60169-15; MIL-C-39012; MIL-STD-348A/310

Electrical Data

Impedance 50 Ω
Frequency DC to 27 GHz
VSWR (Return Loss) ≤ 1.20 (≥ 20.83 dB)
Insertion Loss ≤ 0.05 x √F (GHz) dB

Mechanical Data

Coupling mechanisms SMP (Snap-on); Precision SMA (Screw-lock)
Weight N/A

Environmental Data

Temperature range -65°C to +155°C
RoHS compliant

Material And Plating

Piece Parts (SMP)	Material	Plating
Centre contact	Beryllium Copper	Gold plating(Nickel underplated)
Body	Stainless Steel	Passivated
Insulator	PTFE	
Piece Parts (SMA)	Material	Plating
Centre contact	Beryllium Copper	Gold plating(Nickel underplated)
Body	Stainless Steel	Passivated
Insulator	PTFE	

Packing

Single or 100