

Panel Adaptor plug/jack  
SMP plug (male) / Precision SMA jack (female)

AD-PCM1PCA25A-PT/9X-9X

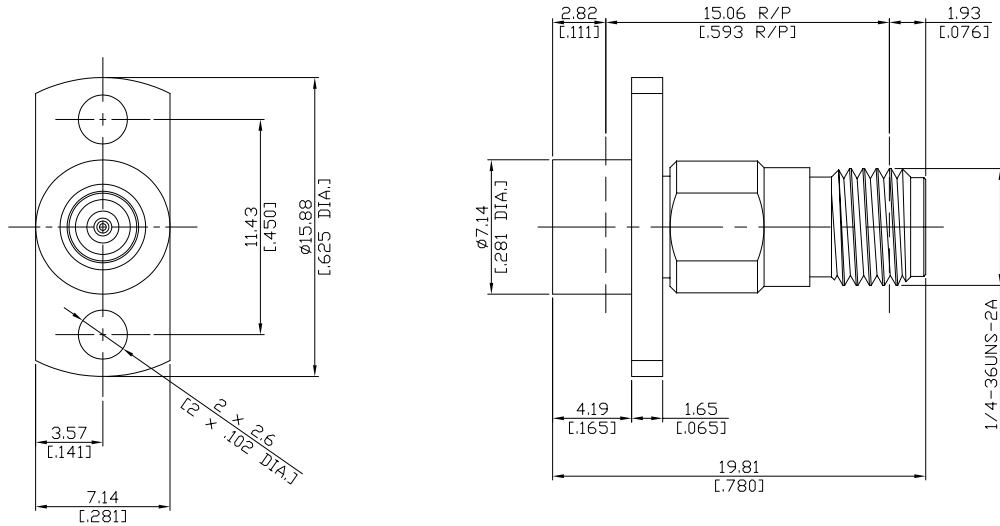

All dimensions are in mm [inch]

Tolerances according to DIN ISO 2768-mH

**Interface**

SMP (catchers mit) according to  
SMA according to

MIL-STD-348/326.5  
IEC 60169-15; MIL-C-39012; MIL-STD-348A/310

**Electrical Data**

Impedance 50 Ω  
Frequency DC to 27 GHz  
VSWR (Return Loss) ≤ 1.20 (≥ 20.83 dB)  
Insertion Loss ≤ 0.05 x √F (GHz) dB

**Mechanical Data**

Coupling mechanisms SMP (Snap-on); Precision SMA (Screw-lock)  
Weight N/A

**Environmental Data**

Temperature range -65°C to +155°C  
RoHS compliant

**Material And Plating**

Piece Parts (SMP)	Material	Plating
Centre contact	Beryllium Copper	Gold plating(Nickel underplated)
Body	Stainless Steel	Passivated
Insulator	PTFE	
Piece Parts (SMA)	Material	Plating
Centre contact	Beryllium Copper	Gold plating(Nickel underplated)
Body	Stainless Steel	Passivated
Insulator	PTFE	

**Packing**

Single or 100