

Bulkhead adaptor plug/plug
Precision SMA plug (male) / Precision SMA plug (male)

AD-PCA1PCA15A-BH/111-111

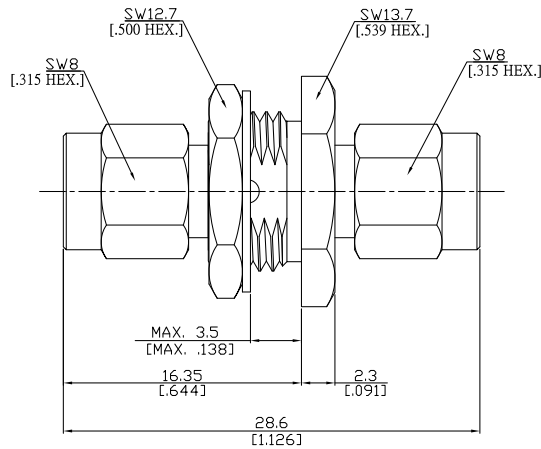

All dimensions are in mm [inch]
Tolerances according to DIN ISO 2768-mH

Interface

According to IEC 60169-15; MIL-C-39012; MIL-STD-348A/310

Electrical Data

Impedance 50 Ω
Frequency DC to 27 GHz
VSWR ≤ 1.15 (≥ 23.13 dB)

Mechanical Data

Coupling mechanisms Screw-lock
Weight 0.0108 kg

Environmental Data

Temperature range -65°C to +125°C
RoHS compliant

Material And Plating

Piece Parts (Precision SMA)	Material	Plating
Centre contact	Brass	Gold plating (Nickel underplated)
Body	Brass	Passivated
Insulator	PTFE	
Gasket	Silicone Rubber	
Coupling nut	Brass	Gold plating (Nickel underplated)
Fastening nut	Brass	Gold plating (Nickel underplated)
Washer	Brass	Gold plating (Nickel underplated)
Piece Parts (Precision SMA)	Material	Plating
Centre contact	Brass	Gold plating (Nickel underplated)
Body	Brass	Gold plating (Nickel underplated)
Insulator	PTFE	
Gasket	Silicone Rubber	
Coupling nut	Brass	Gold plating (Nickel underplated)

Packing

Single or 100

Related Document

Mounting Dimension MD6