

Adaptor Plug / Jack
N plug (male) / MCX jack (female)

AD-N1M25A/144-91

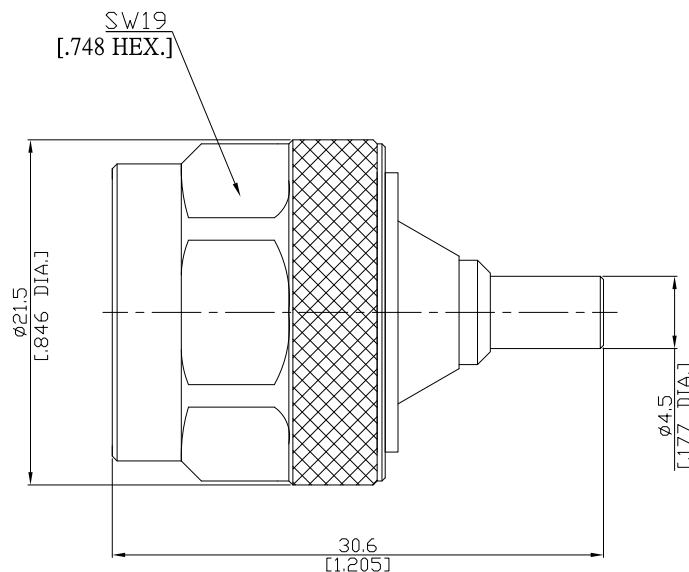

All dimensions are in mm [inch]
Tolerances according to DIN ISO 2768-mH

Interface

N according to
MCX according to

IEC 60169-16; MIL-C-39012; MIL-STD-348A/304
IEC 60169-36

Electrical Data

Impedance

50 Ω

Frequency

DC to 6 GHz

VSWR (Return Loss)

≤ 1.20 (≥ 20.8 dB)

Insertion Loss

$\leq 0.05 \times \sqrt{F}$ (GHz) dB

Mechanical Data

Coupling mechanisms

N (Screw-lock) ; MCX (Snap-lock)

Weight

0.0283 kg

Environmental Data

Temperature range

-55°C to +165°C

RoHS

compliant

Material And Plating

Piece Parts (N)	Material	Plating
Centre contact	Brass	Gold plating(Nickel underplated)
Body	Brass	Copper-Tin-Zinc Alloy
Insulator	PTFE	
Gasket	Silicone Rubber	
Coupling nut	Brass	Copper-Tin-Zinc Alloy
Piece Parts (MCX)	Material	Plating
Centre contact	Beryllium Copper	Gold plating(Nickel underplated)
Body	Brass	Gold plating(Nickel underplated)
Insulator	PTFE	

Packing

Single or 100