

**Bulkhead Adaptor Plug/Plug  
SMA Plug (male) / SMA Plug (male)**

**AD-A1A15A-BH/1XX-1XX**

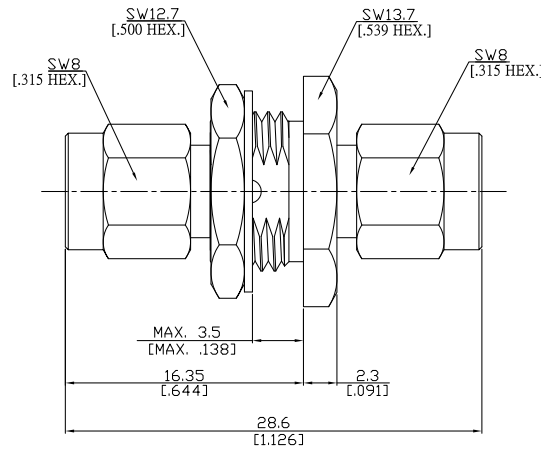

All dimensions are in mm [inch]  
Tolerances according to DIN ISO 2768-mH

**Interface**

According to IEC 60169-15; MIL-C-39012; MIL-STD-348A/310

**Electrical Data**

Impedance 50 Ω  
Frequency DC to 18 GHz  
VSWR ≤ 1.15 (≥ 23.1 dB)

**Mechanical Data**

Coupling mechanisms Screw-lock  
Weight 0.0108 kg

**Environmental Data**

Temperature range -65°C to +125°C  
RoHS compliant

**Material And Plating**

Piece Parts (SMA)	Material	Plating
Centre contact	Brass	Gold plating(Nickel underplated)
Body	Stainless Steel	Passivated
Insulator	PTFE	
Gasket	Silicone Rubber	
Coupling nut	Stainless Steel	Passivated
Fastening nut	Stainless Steel	Passivated
Washer	Stainless Steel	Passivated
Piece Parts (SMA)	Material	Plating
Centre contact	Brass	Gold plating(Nickel underplated)
Body	Stainless Steel	Passivated
Insulator	PTFE	
Gasket	Silicone Rubber	
Coupling nut	Stainless Steel	Passivated

**Packing**

Single or 100

**Related Document**

Mounting Dimension MD6