

7/16(Male) Straight Cable Plug

716-1C50-EZR400A/144

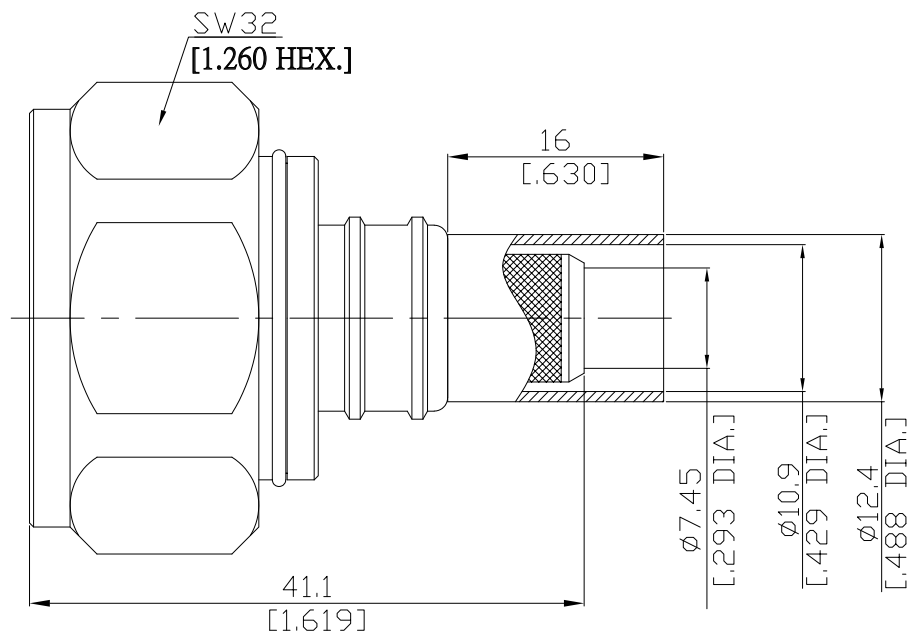

All dimensions are in mm [inch]

Tolerances according to DIN ISO 2768-mH

Interface

According to IEC 61169-4

Electrical Data

Impedance 50 Ω
Frequency DC to 7.5 GHz
VSWR (Return Loss) ≤1.30 (≥ 17.69 dB)

- Limitations are possible due to the used cable type and manufacturing process -

Mechanical Data

Coupling mechanisms Screw-lock
Centre contact Plug-In
Cable entry Crimped

Environmental Data

Temperature range -65°C to +165°C
RoHS compliant

Material And Plating

Connector parts	Material	Plating
Centre contact	Brass	Gold plating (Nickel underplating)
Body	Brass	Copper-Tin-Zinc Alloy
Insulator	PTFE	
Gasket	Silicone Rubber	
Coupling nut	Brass	Copper-Tin-Zinc Alloy
Crimp ferrules	Brass	Copper-Tin-Zinc Alloy

Suitable Cables

LMR 400, RNL-400, RG-213*, RG-8*

* It is necessary to apply liquid tin to the center conductor before plugging it in.

Packing

Single or 100



7/16(Male) Straight Cable Plug

716-1C50-EZR400A/144

Recommended Cable Stripping Dimensions

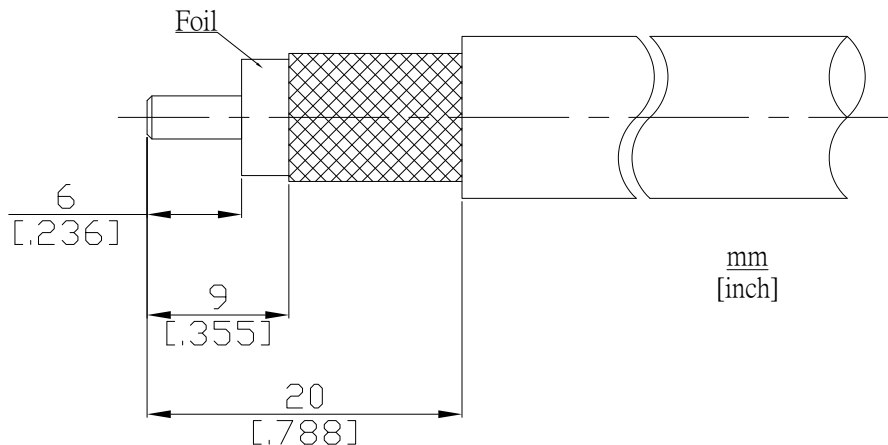

Please note: It is necessary to apply liquid tin to stranded center conductors before plugging them into the connector.

Crimp Dimensions [HEX]

Crimp ferrule

10.90 mm [.429 inch]