

75 Ohm 1.6-5.6 Jack (Female) Bulkhead Mount Connector Crimp
Solder Contact Attachment for HUAWEI E1 Cable

16562CA70-E1A/H3

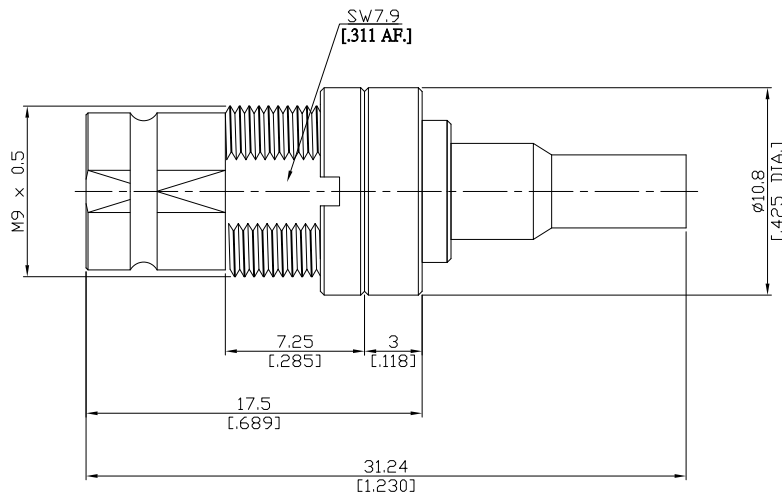

All dimensions are in mm [inch]
Tolerances according to DIN ISO 2768-mH

Interface

According to IEC 60169-13

Electrical Data

Impedance 75 Ω

- Limitations are possible due to the used cable type and manufacturing process -

Mechanical Data

Coupling mechanisms Screw-lock, snap-on, and slide-in
Mating Cycles ≥ 500
Centre contact Soldered
Cable entry Crimped

Environmental Data

Temperature Range -65°C to +165°C
RoHS compliant

Material And Plating

Piece Parts	Material	Plating
Centre contact	Phosphor Bronze	Gold plating, 3 μinch (Non-magnetic nickel-phosphorus underplating, 80 μinch)
Body	Brass	Nickel
Insulator	PTFE	
Crimp ferrules	Brass	Nickel

Suitable Cables

Huawei E1

Packing

Single or 100